

**Z6 Foldable 5-in-1 15W Magnetic  
Wireless Charger with Flashy  
Atmosphere Light/Digital Clock  
Multi-Function Wireless Charging Stand**

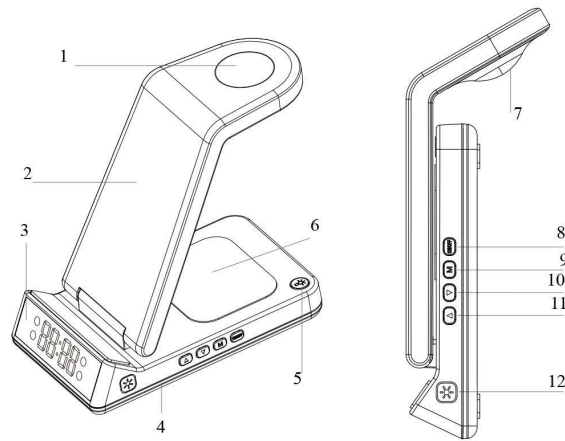

## Schematic diagram



1. Smart watch wireless charging area
2. Mobile phone charging area
3. Time display
4. Mobile phone charging indicator
5. Small nightlight switch
6. Wireless earphone/mobile phone charging area
7. Small nightlight
8. Clock display switch on/off
9. Mode
10. Down key
11. Up key
12. Mobile phone charging indicator switch

## Charging mode

1. When powered on, the indicator light flashes and then turns off, indicating that the product is in standby.
2. Aim the charging product at the induction area of the product, the indicator light is always on, and it enters the charging state.
3. Remove the charging product, the indicator light turns off, and the product returns to the standby state.

## Introduction to Clock

1. In addition to displaying the time, there are corresponding small icons State display : time/clock/AM/PM;
2. Turn on the alarm clock function, the alarm clock icon will be on, and it will be off when it is turned off;
3. The default is clock mode when powered on, the time icon is on, and when entering the setting mode, the time icon is off.



### Alarm Clock Instruction:

1. Long press the up button for 3 seconds to turn on the alarm, and long press the up button for 3 seconds to turn off the alarm. After the alarm clock function is turned on, the last set alarm time will be used continuously.
2. Short press the mode key for 1 second, the alarm clock icon will flash, press the up and down keys to set the alarm time, after setting the alarm, the default is to start the alarm function every day.

### Clock function introduction:

- Long press the mode button for 3 seconds, the time icon will flash, press the up and down buttons to set the time, and press the mode button to confirm after adjusting the time.

## Introduction to Clock

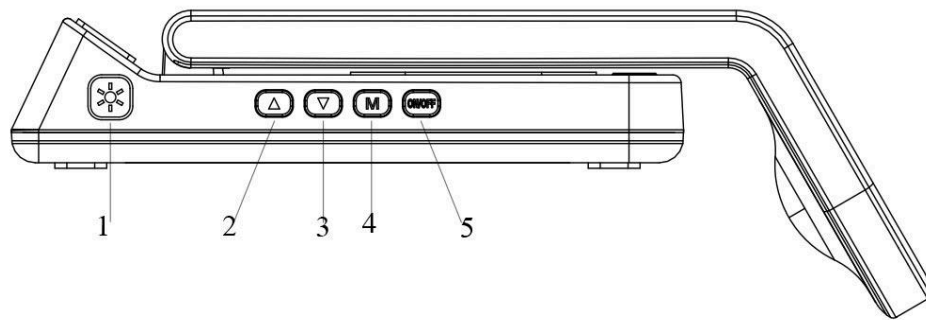

1. Mobile phone charging indicator
2. Up key
3. Down key
4. Mode
5. Clock display switch on/off

1. The LED light is on by default, and the LED light is off when you press this button for a short time.
2. Mode button : Short press to enter the alarm setting mode. By default, the two digits of the hour are set first, which can be adjusted by the up and down keys, and then a short press of the mode key to switch to the two digits of the minute, and then a short press of the mode key to exit, and a long press 3 seconds into the time setting mode, the adjustment operation is consistent with the alarm mode.
3. Up button: When entering the setting mode, short press to increase by 1, long press to quickly increase, in clock mode, long press this key for 2 seconds to turn on or off the alarm, short press has no function.
4. Down button: When entering the setting mode, short press to decrease by 1, long press to decrease rapidly, in clock mode, long press this button for 2 seconds to turn on or off the alarm, short press has no function.

Equipped with a CR2032 button battery. When the external power supply is disconnected, the LED lights are all off. At this time, the button battery is only used as a time memory function.

Equipped with a buzzer, the alarm will ring when the alarm function is triggered, and it will automatically turn off after 5 minutes of ringing. You can also press any key to turn off the alarm.

## Specification

Input: QC/PD 18W Type-C

Output: 5W/7.5W/10W/15W (Smart Phone)

Output: 5W (TWS)

Size: 1697557mm

Transmission Distance: 3–8mm

USB Output: 5V–1.5A

Output: 2.5W (Smart Watch)

Weight: 192G

Conversion Efficiency: 80%–85%

Color: Black / White (Support customized)

## Safety Notice

1. When using fast charging, please use a qualified QC3.0 charging source adapter and fast charging cable, otherwise it may cause unstable charging.
2. Do not put metal objects or magnetic cards on the charging board, which may cause damage or abnormality of the charger.
3. If the receiving coil or the transmitting board is overheated during use and stops charging, please remove the charging product and try charging again after cooling down.
4. Do not disassemble the product or in fire, water, and avoid causing a short circuit.
5. Do not place the product in extremely hot, humid or corrosive environments, to avoid damage to the product.
6. Do not give children to play, in order to avoid unnecessary accidents.

## FAQ

Is the phone not charging?

- The phone is not aligned with the sensing area or the receiving coil is not installed correctly.

Heats up while charging?

- It is normal for the receiving coil or the transmitting board to heat up during the wireless charging process.

Phone charging intermittently?

- A. If the charging current of the adapter is not enough or the voltage is unstable, please use the QC3.0 fast charging adapter to charge.
- B. The charging position is too biased, and the electromagnetic induction is not good. The charging position can be adjusted.

The main unit indicator light is normal, but the mobile phone does not work?

- The receiving coil of the mobile phone is faulty, it is recommended to update the receiving coil or repair the mobile phone (built-in receiving coil).